

WING WALL

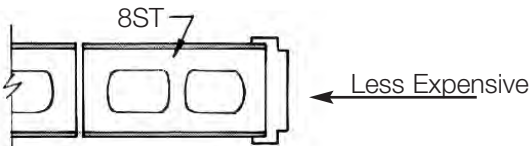

Wrap Around Door Frames.
Save Two Expensive Shapes.

Use 2" shapes on
the top and end.

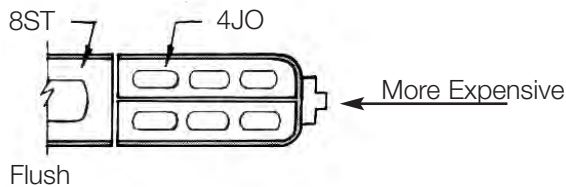
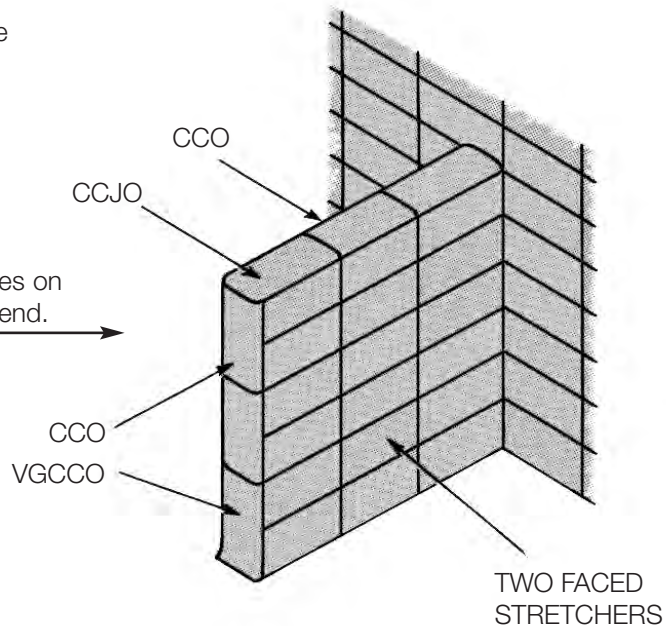

DOUBLE FACED BLOCKS

An Astra-Glaze-SW+ double faced concrete masonry unit is a single concrete block with a glazed face on both sides. The use of double faced units affords significant cost savings -- walls finished on both sides are completed in a single operation.

PLEASE NOTE THE FOLLOWING LIMITATIONS:

Masons lay block or bricks to one side using a line. This means they are facing one side of the wall when the masonry product is placed and cannot see what the other side looks like. Periodically, the mason can check the opposite side and make slight adjustments -- but not major changes. If units are not aligned properly on the face side of the wall, the error multiplies substantially on the opposite side. This is amplified as the wall length increases. What is rather inconsequential on smaller wall lengths can become significant on longer lengths. Manufacturer accepts no responsibility for face alignment.

With the commonly used methods of laying masonry to one side of a wall, it can almost be assured one side will be better aligned than the other.

Scoring is not recommended for double face units as it will compound any alignment imperfections.



architectural masonry units

Column Details

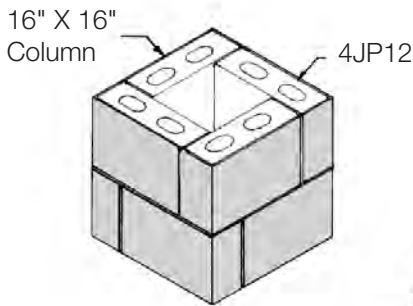

16" X 16"
Column

4JP12



Almost any column size can be made with 4JP12 units.

Eliminates the need for more costly 8JP/JO units.

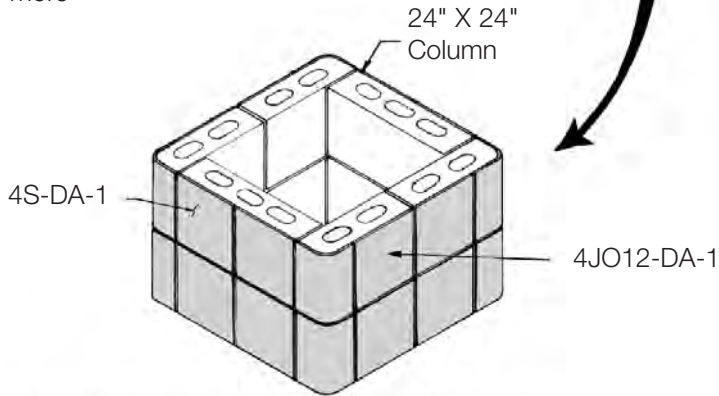

24" X 24"
Column

4S-DA-1

4JO12-DA-1

⊘ Use 4JO/JP12s instead of 8JO's

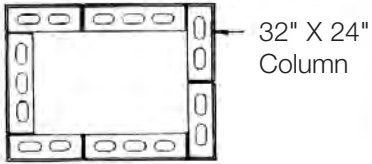

32" X 24"
Column

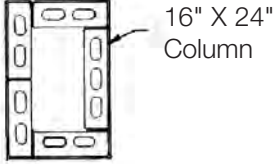

16" X 24"
Column

BOND BEAM

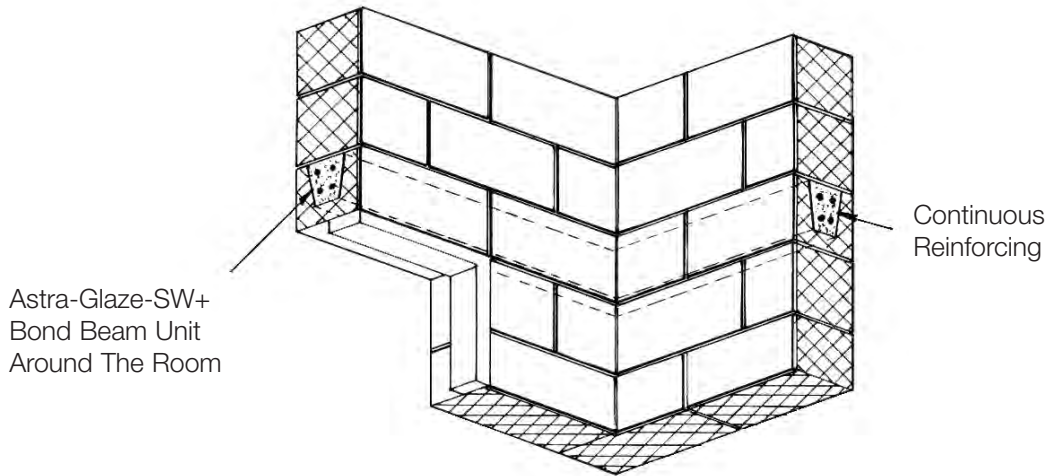

SCORED JOINTS

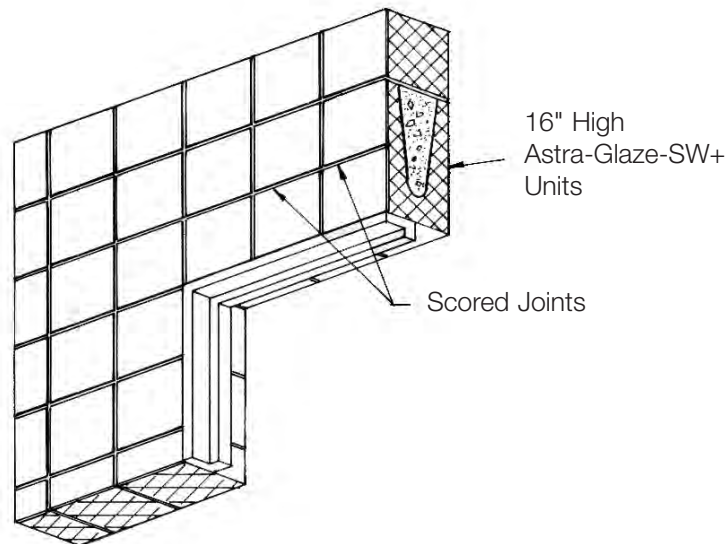



architectural masonry units

BULLNOSE JAMB MEETING BULLNOSE SILL

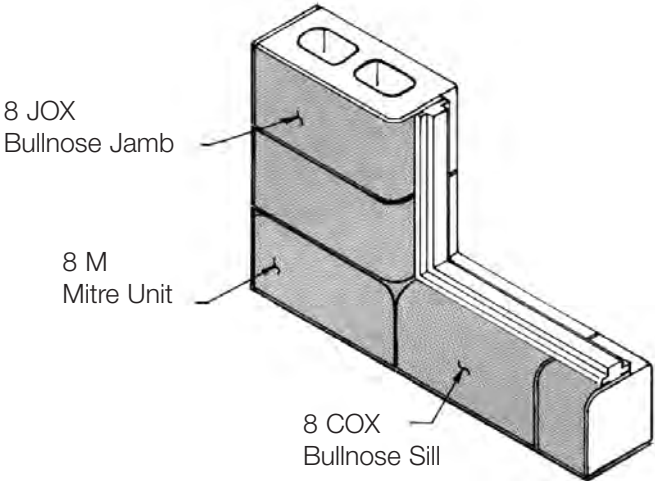

TYPICAL 135° CORNER

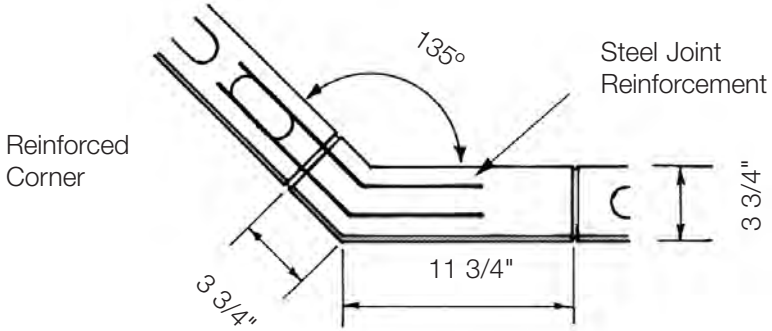

6" Wall Outside
Corner

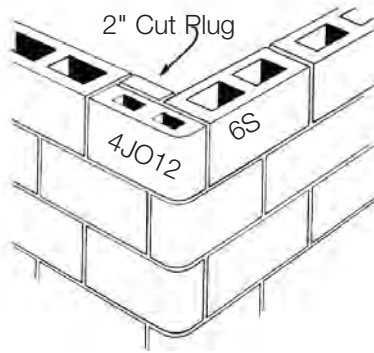

8" Wall Outside
Corner

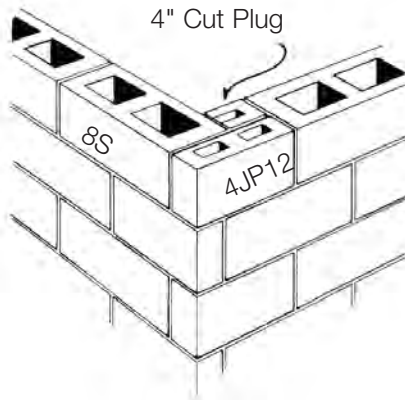

12" Wall Outside
Corner

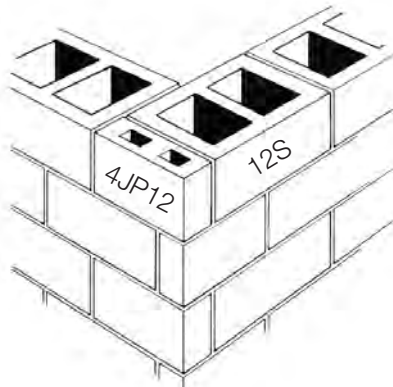



architectural masonry units

Design Details

Astra-Glaze-SW+®

DOOR AND BASE DETAIL

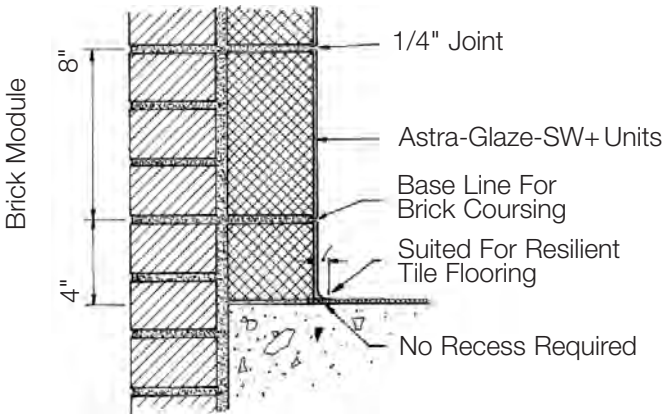
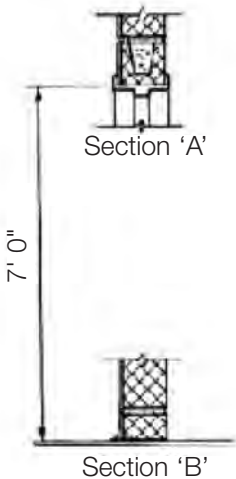
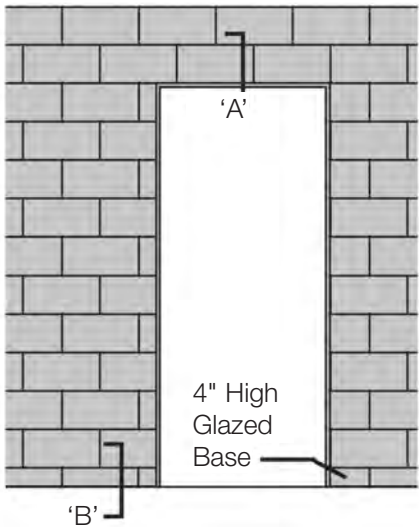

DOOR AND BASE DETAIL

Using standard Astra-Glaze-SW+ units:

Length of Unit (Inches)	Depth of Unit (Inches)	= Smallest Radius (Without Cutting)	= Overhang* (Inches)
7 5/8	3 5/8	6' 6"	7/64
11 5/8	3 5/8	9' 8"	5/32
7 5/8	7 5/8	8' 0"	3/32
15 5/8	7 5/8	15' 10"	5/32

*Overhang projection in running bond.

CURVED MASONRY WALLS

Using Radius blocks:

Standard 12" and 27" Radius Block Corner Detail

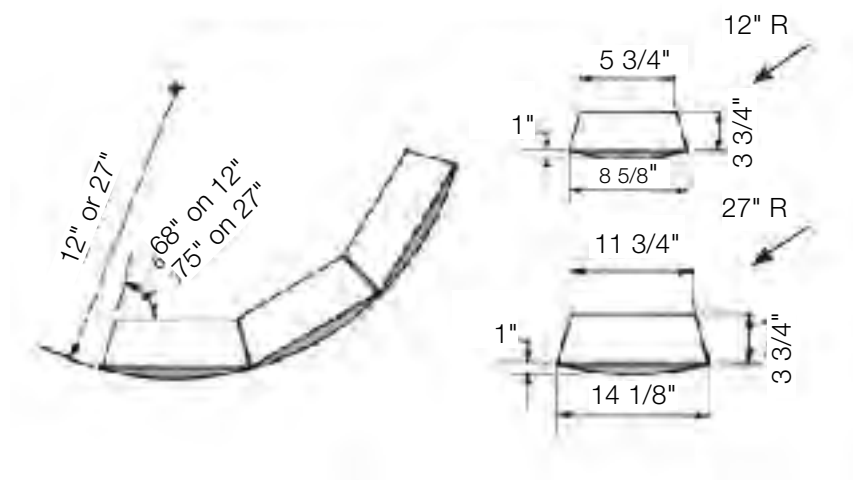

JAMB UNIT ALTERNATIVES

1. Astra-Glaze-SW+ jamb units are expensive.
2. The elimination of jamb units through the use of wrap-around or flush door frames reduces cost substantially.
3. The use of a 7'2" door with a 7'4" flush frame works well with Astra-Glaze-SW+ units. The 7'2" door can be used with a surface mounted door closer. The increased cost of a 7'2" door (as compared to a 7'0" door) is more than compensated for by the fact that a surface-mounted door closer is less expensive than the internal door closer which is required for shorter doors.
4. Use of the floor to ceiling wrap-around or flush door frames provide a "built-in" control joint for expansion and contraction.

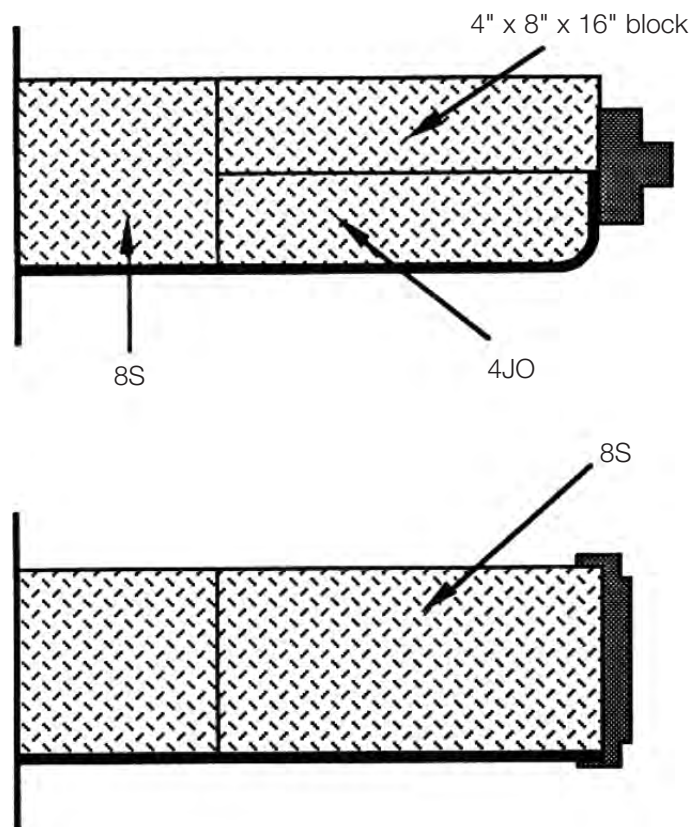

Recommended Mortars

Various masonry mortars may be used with Astra-Glaze-SW+ concrete masonry units depending on specific structural requirements for the finished walls. Refer to NCMA TEK Notes, available at www.trenwyth.com, for mortar details.

For all exterior mortar, use an approved matching water repellent mortar additive (which may be purchased from manufacturer.) Follow manufacturer's instructions in all mortar applications. Consult manufacturer for recommendations.

Epoxy Finished Joints

In areas exposed to excessive moisture, make sure to tool mortar joints with a minimum of 1/4" and tuckpoint with an approved water-resistant grout. A typical tuckpointing grout is BONSAL® POLYMER MODIFIED SANDED TILE GROUT mixed with the BONSAL B-7000 EPOXY. Do not add water or anything else in addition to the B-7000, which will make it a 100% solid enabling it to be acid and stain resistant.

DO NOT FLOAT GROUT ACROSS GLAZED SURFACE AS THIS MAY CAUSE DAMAGE TO THE GLAZED FACE. WHEN USING AN EPOXY GROUT, THE PROPER TECHNIQUE IS TO TUCKPOINT USING A MORTAR GUN OR BAKER'S BAG!

Mortar Joints

The proper mortar joint size to use when laying Astra-Glaze-SW+ blocks is 1/4" at the face and 3/8" joints in the concrete block backing.

It is important to realize that the glazed facing overlaps the concrete masonry units and is larger than the block itself. Lay all Astra-Glaze-SW+ units to the face ensuring 1/4" joint measured from the center to center of adjacent edge radii. See below.

